

26" x 30" Bolt Plate DHPRT

(Double Hung Pre-Rigged Truss)

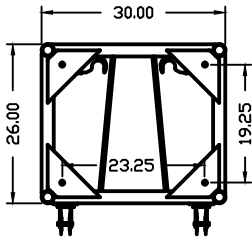
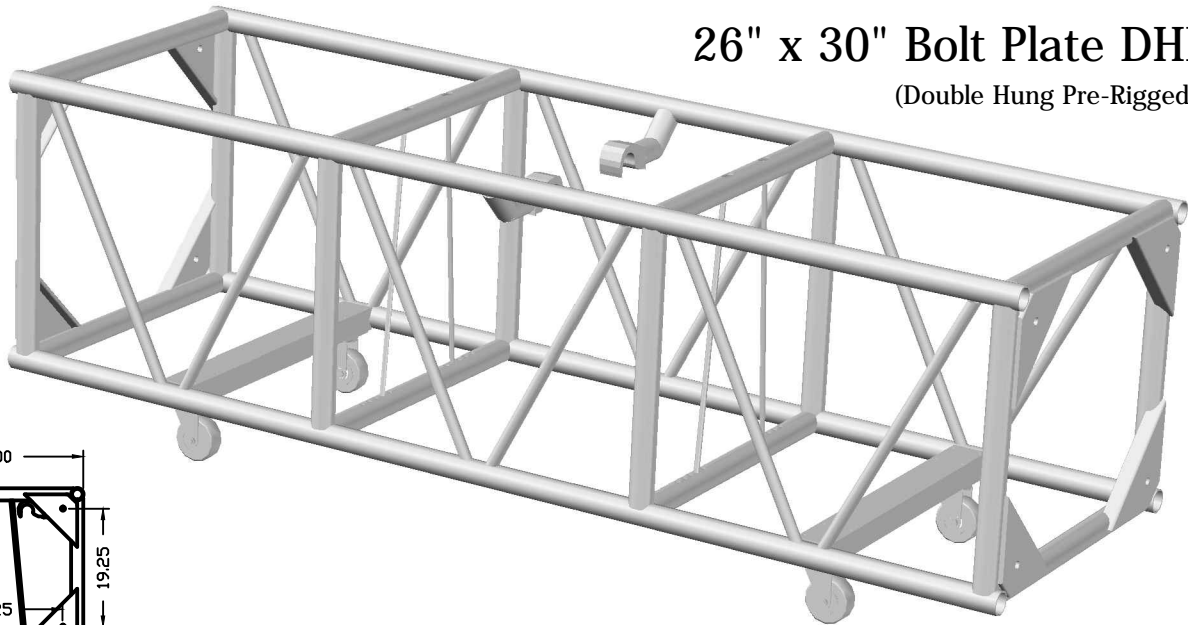

Reliable Design Services - 26"x30" Bolt Plate Connected Pre-Rig Truss Maximum Allowable Superimposed Gravity Loads

| Span (ft) | Uniformly Distributed | | | Center Point Loads | | Third Point Loads | | Quarter Point Loads | | Fifth Point Loads | |
|-----------|-----------------------|------------------|----------------|--------------------|----------------|-------------------|----------------|---------------------|----------------|-------------------|----------------|
| | UDL (plf) | Total Load (lbs) | Max Defl. (in) | Load (lbs) | Max Defl. (in) | Load (lbs) | Max Defl. (in) | Load (lbs) | Max Defl. (in) | Load (lbs) | Max Defl. (in) |
| 7.75 | 1276 | 9887 | 0.02 | 1 @ 9331 | 0.04 | 2 @ 4944 | 0.03 | 3 @ 3296 | 0.03 | 4 @ 2472 | 0.03 |
| 15.5 | 593 | 9191 | 0.18 | 1 @ 4596 | 0.15 | 2 @ 3450 | 0.19 | 3 @ 2298 | 0.17 | 4 @ 1915 | 0.18 |
| 23.25 | 257 | 5973 | 0.41 | 1 @ 2986 | 0.33 | 2 @ 2242 | 0.42 | 3 @ 1493 | 0.39 | 4 @ 1244 | 0.41 |
| 31 | 139 | 4317 | 0.73 | 1 @ 2158 | 0.60 | 2 @ 1620 | 0.75 | 3 @ 1079 | 0.70 | 4 @ 899 | 0.74 |
| 38.75 | 85 | 3286 | 1.14 | 1 @ 1643 | 0.94 | 2 @ 1233 | 1.17 | 3 @ 821 | 1.09 | 4 @ 685 | 1.15 |
| 46.5 | 55 | 2568 | 1.65 | 1 @ 1284 | 1.37 | 2 @ 964 | 1.68 | 3 @ 642 | 1.58 | 4 @ 535 | 1.66 |
| 54.25 | 37 | 2028 | 2.24 | 1 @ 1014 | 1.90 | 2 @ 761 | 2.28 | 3 @ 507 | 2.16 | 4 @ 423 | 2.25 |

Notes:

1. The following abbreviations have been utilized in the above table:

- UDL Uniformly Distributed Load
- Calc. Defl. Calculated Deflection
- plf Pounds Per Lineal Foot
- ft Feet
- lbs Pounds
- in Inches

2. The loads outlined in the above table are for the Reliable Design Services 26"x30" Plate Connected Pre-Rig Truss

This truss has 2" diameter x 1/8" thick aluminum chords, 2" x 1" x 1/8" thick aluminum end members, 2" diameter x 1/8" bottom horizontals, and 1" diameter x 1/8" thick aluminum diagonals.

3. The Uniformly Distributed Load is only allowable if it is truly distributed uniformly across the span of the truss.

4. The Center Point Loads reported are the maximum allowable point loads applied at the center of a span of this truss.

5. The Third Point Loads reported are the maximum allowable point loads applied at each third point along a span of this truss.

6. The Quarter Point Loads reported are the maximum allowable point loads applied at each quarter point along a span of this truss.

7. The Fifth Point Loads reported are the maximum allowable point loads applied at each fifth point along a span of this truss.

8. The self weight of the truss has been taken into account in the preparation of this load table. Therefore, the user need not subtract the weight of the truss from the provided loads.

9. The loads tabulated above only include static (non-moving) loads. Dynamic (moving) or shock loads have not been considered.

10. Lateral (sideways) loads have not been considered in the calculations of the loads tabulated above. The truss has no diagonals in the bottom face and should not be laterally loaded.

11. Seismic and wind loads have not been considered in the calculations of the loads tabulated above.

12. The deflections tabulated above are based upon connections allowing no movement. Due to clearances required to assemble the multiple trusses into a single span, actual deflections may be slightly higher than the tabulated values.

13. This table was prepared by Michael Lea Enterprises, Fort Worth, Texas, 76126, 817-454-8032.



(972) 584-0551 WWW.RDS-WEB.COM

| Standard Part #'s and weights (Custom lengths available) | | | | | |
|--|--------------------|---------|--------------|------------------|--------|
| 10' Section | PN#-BP26x30PRTx120 | 138 LBS | 3-Way Corner | PN#- BP26x30-CB3 | 44 LBS |
| 93" Section | PN#-BP26x30PRTx93 | 97 LBS | 4-Way Corner | PN#- BP26x30-CB4 | 51 LBS |